

ELIXIR CRUISE PREVIEW 2024

UNESCO HERITAGE SITES

Book before January 15th 2024 and get a
50% Special Offer Discount

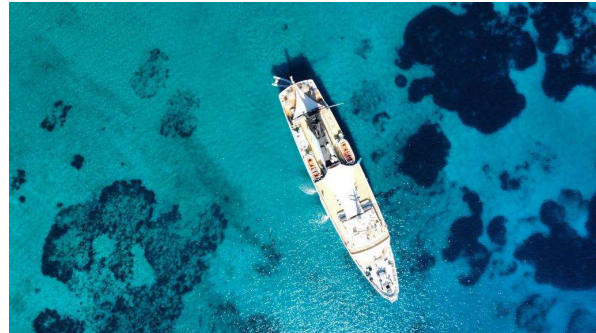

ABOUT ELIXIR CRUISES & THE ELYSIUM

THE ELIXIR DIFFERENCE

Elixir Cruises is about boutique cruising redefined.

It's about unique journeys of discovery of new places and a new you. It's about fun, relaxation and exciting cultural experiences. A holistic approach that embraces mind, body, and soul aboard yacht-like havens of wellbeing, comfort & style.

A completely new concept at sea.

Our first ship, the Elysium, takes you on beautiful, immersive journeys, while rejuvenating, exhilarating and educating you. With only 25 stylish and spacious cabins, a spa, a mini gym, deliciously healthy cuisine, an

array of unparalleled cultural experiences and carefully designed wellness activities, the Elysium will pamper you, spoil you and captivate you forever.

Join us solo, as a couple, with friends or with family. Be active or relaxed. Be as sociable as you like. Make long lasting memories, long lasting friends, or both.

Whichever way you choose, be prepared to embark on one of the most fascinating & enriching experiences of your life.

THE ELIXIR BALANCE[®] CONCEPT

In line with the **Elixir Balance[®]** concept, our cruises offer many activities to mix and match and create your tailor-made journey. In addition to the various cultural and experiential tours, guests can join one of our wellness sessions, enjoy a massage at our spa or choose among a selection of water toys and water sports. Our onboard Wellness Coach and our Cruise Concierge will help you put together the best suited plan for you. Exquisite farm-to-table meals, refreshing drinks, cocktails and fine wines will complement your unique boutique cruise experience.



THE ELYSIUM TECHNICAL SPECIFICATIONS

Vessel Type: Boutique Cruise Ship / Mega Yacht

Length Overall: 63.8 M - **Breadth:** 12.5 M - **Draft:** 3.42 M - **Gross Tonnage:** 1,610 T

Cruising Speed: 10 knots – **Passenger cabins:** 25 - **Guests:** 50 - **Crew:** 24-28

Phos

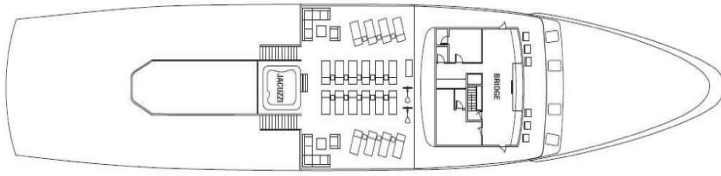

Upper Cabin Deck Astra

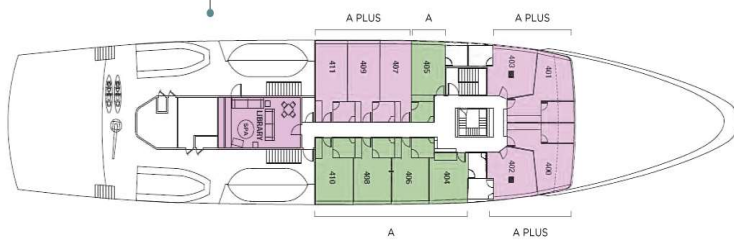

Thalassa

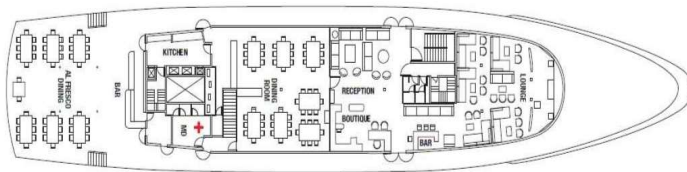

Ammos Lower Main Cabin Deck

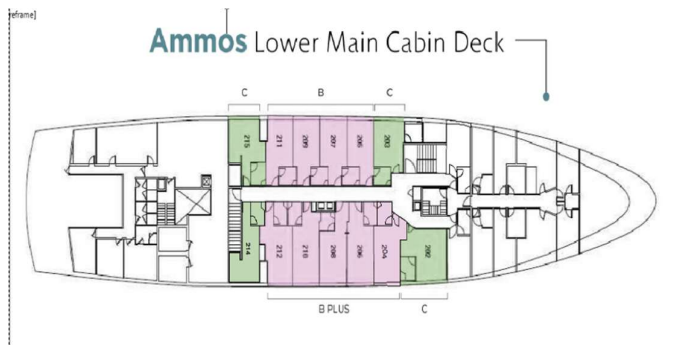

UNESCO HERITAGE SITES ITINERARY

DEPARTURE INFORMATION

Departure port: Lavrion

Departure dates: March 30, April 6 and 13, 2024

(Departing Saturday)

CRUISE ITINERARY

DAY 1 Lavrion

DAY 2 Itea-Delphi

DAY 3 Katakolon (Ancient Olympia)

DAY 4 Gytheio (Mystras)

DAY 5 Elafonissos - Monemvasia

DAY 6 Nafplion ((Mycenae & Epidaurus)

DAY 7 Hydra

DAY 8 Lavrion Port

ACTIVITIES ON THIS CRUISE

Relaxing & Fun: Swimming, snorkeling, water sports, leisurely discovery walks, board games, jacuzzi

Active: Hiking trails, hiking up the “Rock” of Monemvasia, water sport and scuba diving (weather permitting)

Wellness & fitness: Group wellness sessions, spa treatments, gym

Educational: Archaeology seminars with our resident archaeologist, photography walk

Experiential: Greek dances, komboloi workshop, Greek cooking demonstration

Cultural: 5 UNESCO World Heritage Sites, significant archaeological ruins, Byzantine churches, monasteries, museums, medieval towns and villages

Nature: Spectacular coastline, indigenous flora & fauna, Corinth canal

UNESCO: Delphi, Ancient Olympia, Mystras, Monemvasia, Mycenae, Epidaurus

DAY TO DAY ITINERARY

Day 1

Embarkation at Lavrion between 14:00-15:00. Enjoy our signature cocktail during your smooth check-in. Welcome cocktails and dinner are followed by the lifetime experience of crossing the impressively narrow and beautiful Corinth Canal. Overnight at sea.

Day 2

Early morning arrival at Itea, the perfect base for exploring Delphi or the enchanting seaside town of Galaxidi, with our optional tours. The ancient sanctuary of Delphi, a UNESCO World Heritage site, is known as the “navel of the world” from where the Oracle Pythia gave her prophecies. The romantic and tranquil town of Galaxidi has a rich maritime history and was once one of Greece’s wealthiest ports and shipyards. Beautiful neoclassical architecture and pebble covered courtyard are immaculately preserved to this day. Dinner onboard. Overnight at sea to Katakolon.

Day 3

Morning arrival at Katakolon port, our base for exploring Ancient Olympia, another UNESCO World Heritage site of major importance as it is the birthplace of the Olympic Games. To this day the Olympic flame is lit from the rays of the sun at the Temple of Hera and passed on by a High Priestess. Late afternoon we set sail for Gytheion. Dinner onboard and overnight at sea

Day 4

Wake up at the “Land of the Gods”, Gytheio. Gytheio is the site of ancient Cranae, a tiny island where according to legend Paris of Troy and Helen of Sparta spent their first night together before departing for Troy, thus igniting the Trojan War. Explore this relaxing and romantic place or join an optional tour to the stunning fortified settlement of Mystras, yet another UNESCO World Heritage site in our journey. Sitting proudly on mount Taygetos, Mystras served as the capital of the Byzantine settlement of Morea during the 14th and 15th centuries. Lunch on board. In the evening enjoy dinner at one of the many traditional fish tavernas in Gytheion. Overnight at port.

Day 5

In the morning enjoy a swim stop (weather permitting) at the tiny and magical beach of Elafonissos, featuring sand hills and turquoise tropical waters, a NATURA protected habitat. Lunch onboard the Elysium. In the afternoon we arrive at the immaculately preserved medieval town of Monemvasia, meaning “the only entrance”. Explore its fairytale beauty and walk its narrow, pebbled alleys. Enjoy a romantic dinner with local cuisine and wine before returning to Elysium for our overnight sail to Nafplion.

Day 6

After breakfast set out to explore Nafplion and the surrounding area. Take a guided tour to the Ancient City of Mycenae and the ancient sanctuary of Asclepius in Epidaurus, both UNESCO World Heritage sites of great historical significance. Upon return, visit the many museums in Nafplion: the Archaeological Museum, the War Museum, former site of the first Military School in Greece or the Komboloi Museum where you may also participate in a workshop to create your own. Enjoy a romantic evening at one of the most elegant cities in Greece. Overnight at port.

Day 7

Early in the morning we set sail to the Saronic island of Hydra. Enjoy a leisurely walk at one of the most cosmopolitan and equally romantic destinations in Greece. Hydra is an architectural reserve, free of motor vehicles, and summer home to many international celebrities. It has recently been named by UNESCO “The best preserved island in the Mediterranean”. Farewell dinner onboard en route to Lavrion port.

Day 8

Disembarkation at Lavrion port before 10:00, after breakfast.



CABIN CATEGORIES & CRUISE FARES UNESCO HERITAGE SITES

CABIN CATEGORIES	GROSS FARES IN EURO PER PERSON IN DBL/TWIN
Cat C Lower Deck, Twin or Double beds	€ 2,700
Cat B Lower Deck, Twin or Double beds	€ 3,100
Cat B+ Lower Deck, Twin or Double beds	€ 3,300
Cat A Upper Deck, Twin or Double beds	€ 3,950
Cat A+ Upper Deck, Twin or Double beds	€ 4,150
Single Cabin Cat C Lower Deck	€ 2,700
Single Supplement for other categories of cabins	50%
3 rd person discount	50%
Discount for a child 12-15 years old	50%
Port taxes for Ancient Paths - per person, per week	€ 290

Included in the cruise fares

- ▶ Accommodation in twin or double cabins with private bath, individually controlled A/C, snugly all-season duvet, pillow menu, flat screen tv with various channels, music, minibar, personal safe, hair dryer, telephone for internal use, lavish bath products, spa robes and slippers, beach towels
- ▶ Buffet breakfast, half-board and on some days full-board, welcome cocktail, beach BBQ, still water and unlimited filter coffee, tea, cookies station
- ▶ Room service offered without surcharge
- ▶ All advice and group yoga, pilates, aquarobics, meditation sessions with our qualified Wellness Coach
- ▶ Occasional themed seminars by visiting masters
- ▶ Access to mini gym
- ▶ Use of fishing equipment, sanitized snorkeling equipment and water sports equipment
- ▶ Free Wi-fi
- ▶ All advice by our multilingual Cruise Concierge

Excluded from the cruise fares

- ▶ Beverages and alcoholic drinks
- ▶ Optional shore excursions or additional land arrangements
- ▶ Spa treatments
- ▶ Boutique purchases
- ▶ Medical services
- ▶ Water ski & scuba diving
- ▶ Passenger personal expenses
- ▶ Crew gratuities at passenger discretion
- ▶ Hair and nail services
- ▶ Laundry and dry-cleaning services

PAYMENT TERMS

25% deposit upon confirmation of booking

75% balance of payment no less than 90 days prior to embarkation date

CANCELLATION POLICY

15% penalty for cancellation from 120-90 days prior to departure date

25% penalty for cancellation from 89-60 days prior to departure date

50% penalty for cancellation from 59-30 days prior to departure date

100% penalty for cancellation from 29-00 days prior to departure date

ADDITIONAL TERMS

Fares do not include

Port charges, travel insurance, transfers, optional air/sea or land arrangements (unless otherwise specified), optional shore excursions, airport charges. All onboard charges are in Euros.

Children discounted cruise fares

Children between the ages of 12-15 receive a 50% discount on the cruise fare when sharing a cabin with parents - exclusive of port taxes. The Company regrettably does not accept reservations for children under 12 years old (except on scheduled family cruises).

Solo travelers/single supplement

Solo travelers are more than welcome on the cruise, as the Elysium offers many activities and facilities suitable for all types of travelers. Single supplement is set at 50% over current fares. In addition, the

Elysium has a single cabin/no single supplement reserved on priority basis.

Cruise itinerary changes

The carrier reserves the right, at its sole option and discretion and that of the captain of the ship, without liability for damages or refund of any kind, to alter or deviate from the ship's advertised or ordinary itinerary or route due to weather conditions, force majeure, assistance to other ships in distress, saving of life at sea or other extraordinary conditions. Under such extreme circumstances, passengers are not entitled to any claims or refunds. The carrier will however make every effort that passengers access their port of disembarkation on time for their outwards flights.

HEALTH PROTOCOLS

The health and well-being of passengers and crew is our highest priority. The smaller, more intimate size of the Elysium is on its own an assurance of a higher safety level. Due to Covid-19, we are taking additional steps and applying even more rigorous cleaning and disinfecting protocols. We are actively following all World Health Organization updates regarding Covid-19 and adjust our strategies accordingly, to ensure we meet the latest guidance of hygiene and cleaning.

These are some of the measures applied on board the Elysium.

- Crew members are monitored daily for good health
- UV sterilization of all staterooms and public areas
- Use of approved disinfecting cleaning products effective against viruses
- Strict cleaning and disinfecting protocols are also applied “behind the scenes” in areas like the kitchen, laundry room, crew quarters
- Air management, enhanced filters and other technologies are applied where feasible to ensure fresh air circulation

See you soon onboard the Elysium!

